

DESIGN SKILLS

I, II, & III

TRAINING PROGRAM

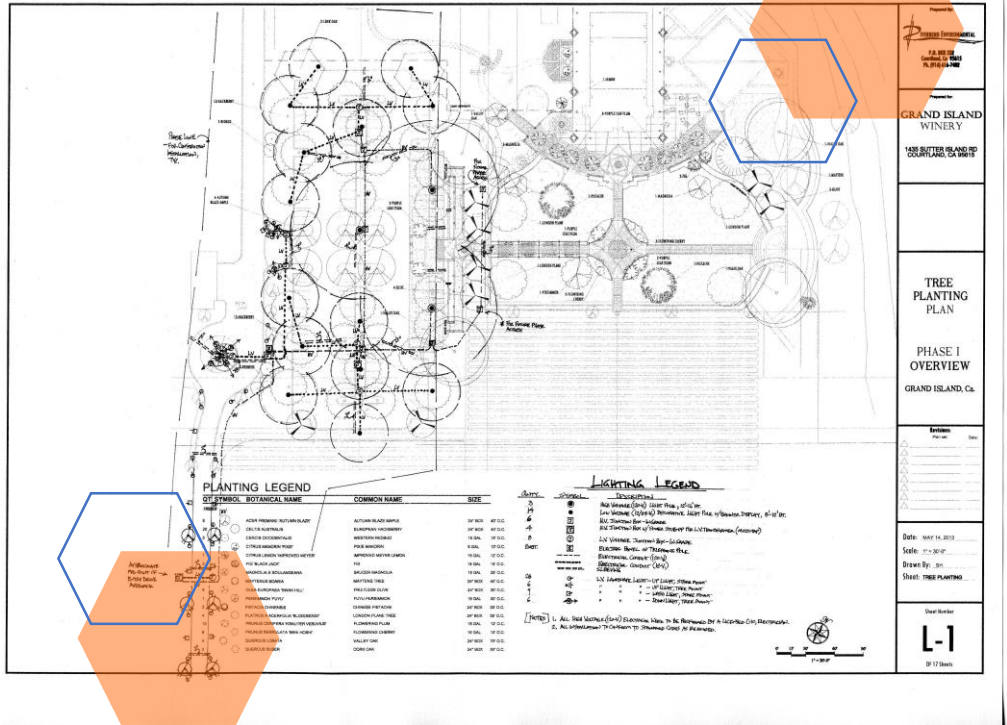

Functional Lighting Designer Skills

WHAT AND WHO SHOULD TAKE THIS COURSE

This course was created to expose landscape lighting practitioners with 'real-world' skills so that they can function in a landscape lighting designer's role. There is little offered to help develop those interested in this specialty trade. ELLI has developed a **3-part program** to address these needs.

Who can benefit from these courses? Anyone intending to perform lighting design skills within landscape lighting work. Ideally, this program is established for newer or entry-level designers, but there are many seasoned providers that don't have these skills.

This course program is essential for functioning as a landscape lighting designer:

Design Skills I:

We will discuss what and how the 'Design Process' works, and describe the practices required of a designer. We'll learn about **Bubble plans & Conceptual plans** and when to use them. And we'll learn how to develop 'Relative-scaled' drawings—a process created and used by Mark Carlson.

Design Skills II:

This second part of the program addresses the **decision-making aspects** of this craft. We'll discuss **Site Analysis** work, job site walk-throughs, and we'll learn how to identify 'lighting' zones. These lighting zones are an important part of addressing purpose—how the space is to be used. Once this is determined, then we can develop the space--atmosphere, mood, task, and function—this is the "Designer's Intent."

Design Skills III:

This last course addresses the importance of **Documentation**. Not only do these records aid your company, but they serve as a form of **legal control**. We'll look at 'As-Build' plans, basic codes, specifications, and details.



COURSE CONTENT

Functional Lighting Designer Skills

Who Is Our Instructor?

When Are These Courses Offered?

Course Sign-up & Cost



Who's Our Educator?

SEASONED PROFESSIONAL PERFORMING THIS WORK

Just like our other course offerings, ELLI employs its instructors based on their 'real-world', professional experience performing the work they are teaching. **Mark Carlson** has been operating as a landscape lighting designer for over 25 years. He still performs this work through his company, Avalon Lighting Design, which is located in the Sacramento region of California.

Mark is highly skilled, has won multiple awards, and has performed internationally. He is the founder of ELLI and has written 2-books: "Lighting Design Awareness" ('22), and "The Original Garden Lighting Book" ('13). Lastly, he spent 10 years serving the AOLP. He was the primary writer and developer of the COLD program ('09) and the Standards for Installation Practices ('12).

Mark also worked at 4 different landscape architectural firms in his career. Most of his work has been with the residential community, but he's designed several commercial & hospitality projects as well. He has performed as an independent provider and as a team member, so he understands both worlds in this craft.

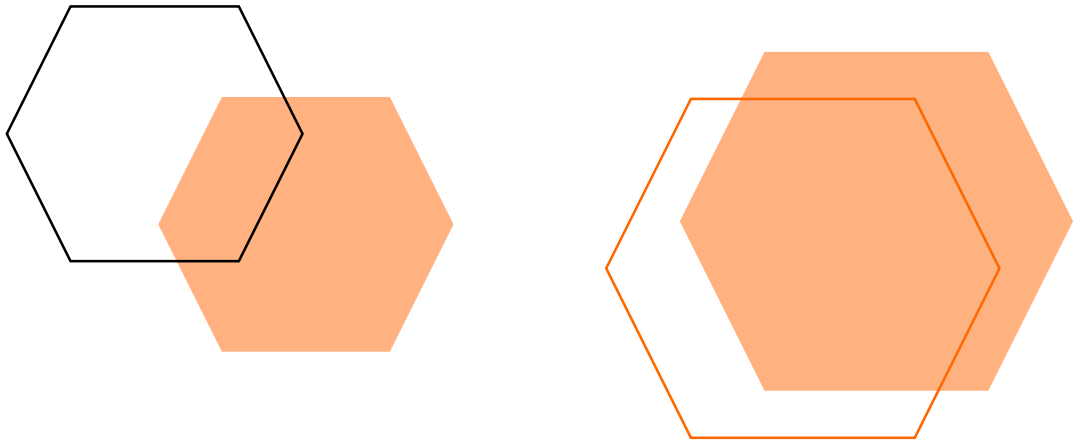

When Are These Courses Offered?

COURSE SESSIONS

The Design Skills program is broken up into 3-parts. Each course provides a particular aspect of learning designer skills. Our goal is to ensure that one can "function" in this role. The whole program covers 10-weeks—Part 1 is 4-weeks, and Part's 2 & 3 are 3-weeks each.

This program will be provided by an online Zoom meeting, where presentation photos can be studied, questions asked, and insights shared. Class sessions will begin after normal work hours and into the early evening. Sessions last from 1 to 2-hours each.

ELLI provides a small group experience for each of its courses. A minimum number of participants will be required to launch the course, as well as a maximum of 8-total will be allowed. This limitation allows for a great learning experience. We have found this to be the best learning environment.



Course Sign-Up & Cost

HOW TO SIGN UP

Those interested in participating and gaining this specialized knowledge must register online at the ELLI website: <https://www.landscapelightinginitiative.org/online-training/>

Group numbers will be assigned depending on the number of participants available for the training schedule. No class group will be smaller than 3 people and up to 8 participants maximum. The cost of this the **Design Skills I** course is **\$550.00** (4 sessions total), **Design Skills II** is **\$450.00** (3 sessions total), and **Design Skills III** is **\$450.00** (3 sessions total).

Interested participants will need to sign-up and pay for the appropriate course listed at the above website link. To see the course descriptions and offerings throughout 2024, please click on the “**Course Descriptions**” button for this list. The following payment types are available: Venmo, PayPal, Visa, MasterCard, or Check. Merchant fees may apply in addition to program costs.

WHY SHOULD I SIGN-UP

There are many reasons to participate in this program, but we’ve provided three (3) primary reasons to do so:

1. The **Design Skills** program will provide an excellent understanding of the most common lighting design skills needed to perform as a landscape lighting designer. ELLI has consolidated these concepts into this offering to allow students to get to work as quickly as possible.
2. This course will essentially build and develop one’s confidence in lighting design skills. We will encourage hands-on practice, so that skills become natural, as well as encourage students to perform ‘mock-ups’ to better learn lighting applications. Our lighting applications program is another important learning tool to consider. Our goal here is to get students to be comfortable working with plans, documenting work, and knowing how to capture information on a site.
3. This course is offered in a small group format, which allows for strong learning. Our instructor will be able to engage in questions, as well as to identify strengths and weaknesses in each participant. This will aid in the success of each participant.